



APPLICATION

The Francis LED searchlight range continues to develop and offers an Efficiently and Environmentally Friendly alternative to traditional lamp sources. Using the highest grade of CREE LED, this range offers a high power output with low power consumption. In addition, the CREE XLamp Series offer a lamp life of 33,000 hours

Francis Searchlights have developed and improved all remote controlled searchlights across the range still further by adding full variable speed, a new modern and sleek joystick control panel, using membrane and LED technology, offering Bus Control, auto home position setting, all at no extra cost, with Optional Controls available on request.

The Francis bus (FBUS) is a custom communication protocol based on RS485 two-wire bi directional communication hardware. The system provides a simple bi directional link between searchlights and control panels.

The 110w LED gives illumination characteristics similar to that of a 1000w halogen lamp. This model offers a remote focus adjustment of the beam from 7° spot to 20° flood.

SPECIFICATION

- 33,000 lamp life hours.
- Toughened super clear Optiwhite front glass.
- Parabolic glass reflector
- Constructed from marine grade materials and fixings.
- Powder coated and stove enamel paint finish.
- Pan rotation 365°.
- Tilt elevation control $\pm 35^\circ$.
- Variable speed LED joystick, with auto home position.
- RS485 connectivity. Dimmable Control Panel.
- Variable Rotation Speed 1 to 60°/sec (Pan).
- Variable Elevation Speed 1 to 17°/sec (Tilt).
- Heater fitted in gearbox & barrel.
- Operational temp -50° .
- Up to 13,900 Lumens.
- Colour Temp options 6500k.
- High quality LED Drivers 50/60 Hz 1ph.
- Sealing - IP67 Gearbox, IP66 Searchlight
- Searchlight weight 32kgs
- Remote Focus fitted as standard.
- Redesigned gearbox housing, incorporating cable termination, for direct connection to the internal LED Driver.

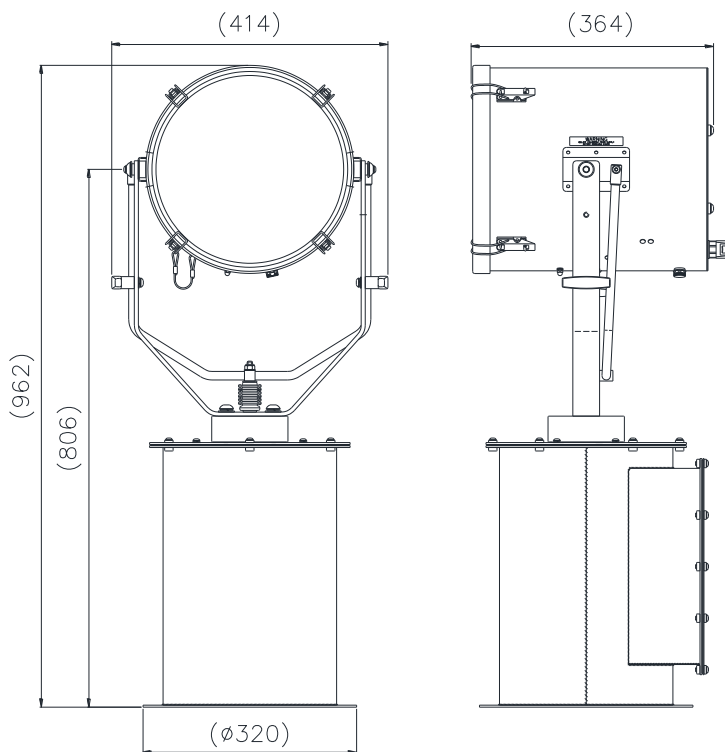

ALL DIMENSIONS IN MILLIMETRES

Base fixing details:
4 holes 12.5 Ø equi-spaced on a 290mm PCD
Joystick panel 120 x 120mm (106 x 106mm cutout)

Part Numbers

| Type | Supply | Watts | Part No |
|--------|----------|-------|---------|
| L300RC | 115/230v | 110w | A7123 |
| L300RC | 24v | 110w | A7199 |

Optional extras:

Computer Control Software
Azimuth LED Control Panel
Master Control Panel (control up to 6 Searchlights)
Slave Control Panels (with full control)
Fiber Optic/TCP/IP Connections
Flir Thermal camera

| VAC | LED life | Range @ 1 Lux | Luminous Flux | Div | Watts |
|---------|------------|---------------|---------------|-------|-------|
| 24-230v | 33,000 hrs | 1089m @ 7°Div | 13,900 | 7-20° | 110w |