

# Francis

S E A R C H L I G H T S

**Light – *in hours of darkness***

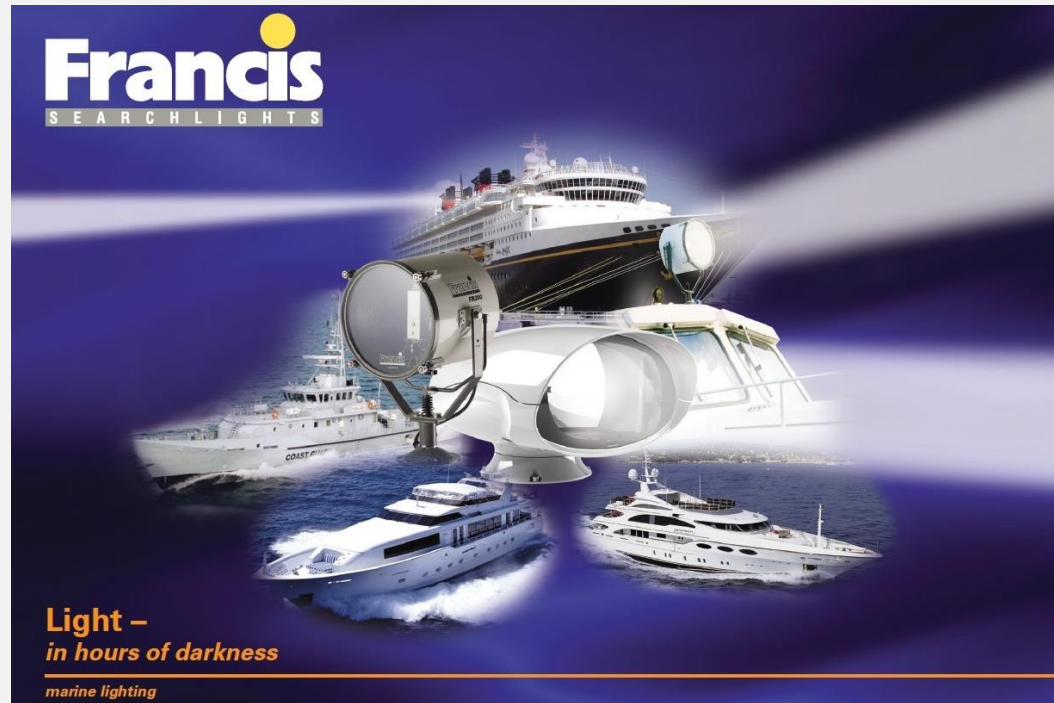



*"There's Nothing More Permanent Than Change "*

Ted Fort OBE - Chairman

Francis Searchlights Limited have designed and manufactured innovative, high quality and competitive lighting products since 1901.

The Company has achieved a Worldwide reputation of the highest standard.

From the purpose built 18,000 sq ft factory premises in Bolton, United Kingdom, the innovative products are developed and manufactured, and include; marine searchlights, vehicle lighting, security and architectural units. Francis Searchlights Ltd is part of the Fort Vale Group of companies, a dynamic and market-driven enterprise with strategic locations throughout the world. The Group is headed by the Chairman, Mr. Ted Fort OBE, himself an accredited Designer and business professional with innovation, flair and drive.





# MARINE



In hours of darkness lives depend on equipment to function quickly and reliably. Searchlights are no exception. Speed is essential and light imperative to see the situation before your next move.

Francis Searchlights provide the peace of mind you experience, knowing you have the best equipment for all eventualities.

Francis provide the ability to see a situation clearly and concisely with the help of 250w to 7Kw searchlights, from 180 to 710mm diameter barrels. The light source provided by a LED, Laser LED, Tungsten Halogen, Metal Halide or Xenon lamps.

Fully focusable with full 365 & 385 degree rotation, the Francis product range can be directly mounted to the deck, deck pedestal, mechanically controlled through a cabin roof or remotely controlled units powered by electric motors.



Francis Searchlights are renowned the world over for quality and longevity in hostile conditions. The comprehensive range of products manufactured by Francis encompasses many special requirements and regulations. The 710mm Suez Canal searchlight includes gas proofed construction, split beam and changeover lamp facility.

The compact FSP 127 (5") MKV signalling lantern fulfils the requirements of the SOLAS "International Convention for the Safety of Life at Sea", full MED approved. This convention states that all ships over 150 tons (gross tonnage), when engaged on International voyages, shall have on board an efficient daylight signalling lamp which shall not be solely dependent upon the ship's main source of electrical power.



Somewhere in the world  
there is always a Francis  
searchlight illuminating  
a hazard, assisting a  
manoeuvre or helping to  
save a life.





# LED TECHNOLOGY

The Francis LED searchlight range has been developed to offer an Efficiently and Environmentally Friendly alternative to traditional lamp sources.

Using the highest grade of LED's Chips, ranging from 100w up to 800w this range offers a high power output with low power consumption. Using a series of precision made glass lenses to optimize and collimate the light output, to achieve a greater range and output, with the average lamp life of 20,000 to 50,000 hours.

Also offering the New 250w & 500w Laser LED Technology, giving the same output as a 2.5Kw & 3.5Kw Xenon Lamp.



L300RC 234w



L230RC 100w



L380RC 600w



250w Laser LED



Navies all over the world rely on communication. Francis Signal Projectors have given reliable service on all seven seas in times of conflict or routine patrols.



Anti Piracy Searchlights are fast becoming the non lethal deterrence of choice in dangerous environments. Francis Searchlights have the largest range available using the either manual or full remote Control options. With the highest power Xenon light & Laser LED sources available, the suspect craft can be fully illuminated, be identified quickly and any necessary evasive action taken immediately.

The power of the searchlight beam renders the intruder helpless and unable to see.



Voyager 2



The Voyager 2 has an excellent range and light output due the use of a high power Xenon & LED light source. This compact high quality unit offers a powerful focusable beam and is particularly suitable for smaller boats, fishing vessels, police launches, coast guard vessels, larger Super Yachts, leisure craft and certain military vehicles.



Francis Searchlights have developed and improved all remote controlled searchlights across the range still further by adding full variable speed, a new modern and sleek joystick control panel, using membrane and LED technology, offering Bus Control, auto home position setting, all at no extra cost, with Optional Controls available on request.

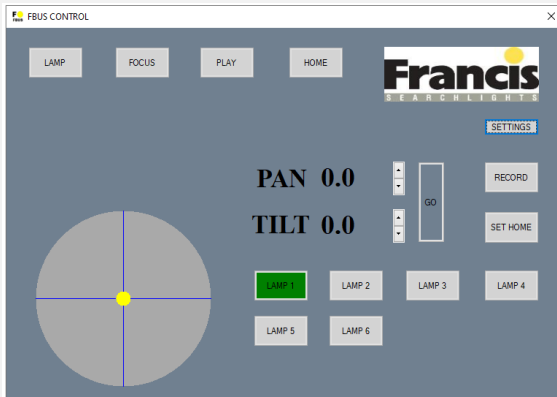

Computer Control Software



Master Control Panel  
(control up to 6 Searchlights)



Azimuth LED Control Panel

Flir Thermal camera

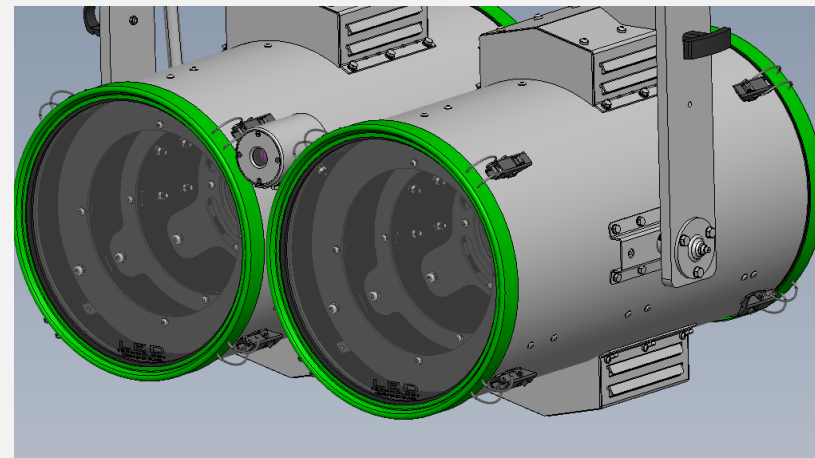



# DEFENCE AND SECURITY

Without a clear picture of a situation as it unfolds, it is difficult to react precisely in tune with the events.

Today's high tech law enforcement environment still lacks the most crucial element of decision making - Visibility.

Threatening situations can develop at a frightening speed, almost at the speed of light. To stay ever vigilant, security forces need to see the situation as it really is only then can the threat be confirmed, measured and contained.

Mounted as part of permanent installations on watch towers, at airports or other secure installations, searchlights can be manually operated through a control linkage within the Tower itself. If necessary, units may be controlled remotely from a command post.



# ARCHITECTURAL & EXTRAVAGANZA

Francis Searchlights Limited are internationally recognised for innovation, design and manufacture of specialised lighting products. Light gives any surface an extra dimension.

Architectural features and areas of interest can be emphasised, focal points sharpened and moods or atmosphere created.

The controllable beam and extended range of the Francis searchlight is ideal for detail lighting and can be focused to a narrow, pencil-like 2 degree beam of light.

Principle elements can be illuminated from a considerable Distance using a Francis searchlight thus avoiding the need for gantries or unsightly brackets. By careful positioning of the light source, away from high inaccessible locations, access for maintenance becomes straightforward.





Francis Searchlights Ltd

Union Road

Bolton

BL2 2HJ

United Kingdom

Our Company Registration Number is: 2503257

Tel: +44 (0)1204 558960

[sales@francis.co.uk](mailto:sales@francis.co.uk)

[www.francis.co.uk](http://www.francis.co.uk)

