

L300RC 110w LED Remote Control Searchlight

The Francis LED searchlight range continues to develop and offers an Efficiently and Environmentally Friendly alternative to traditional lamp sources. Using the highest grade of CREE LED, this range offers a high power output with low power consumption. In addition, the CREE offers a lamp life of 33,000 hours

The 110w LED gives illumination characteristics similar to that of a 1000w halogen lamp. This model offers a remote focus adjustment of the beam from 7° spot to 20° flood.

The Francis bus (FBUS) is a custom communication protocol based on RS485 two-wire bi-directional communication hardware.

Information:

- Toughened super clear Optiwhite front glass.
- Parabolic glass reflector.
- Marine grade materials and fixings.
- Powder coated and stove enamel paint finish.
- Variable speed, with auto home position.
- Dimmable Control Panel.
- Heater fitted in gearbox, barrel optional.
- Remote Focus.
- Direct cable connection to the internal LED Driver.

Optional extras:

- Computer Control Software
- Azimuth LED Control Panel
- Master Control Panel (control up to 6 Searchlights)
- Slave Control Panels (with full control)
- Fiber Optic/TCP/IP Connections
- Flir Thermal camera

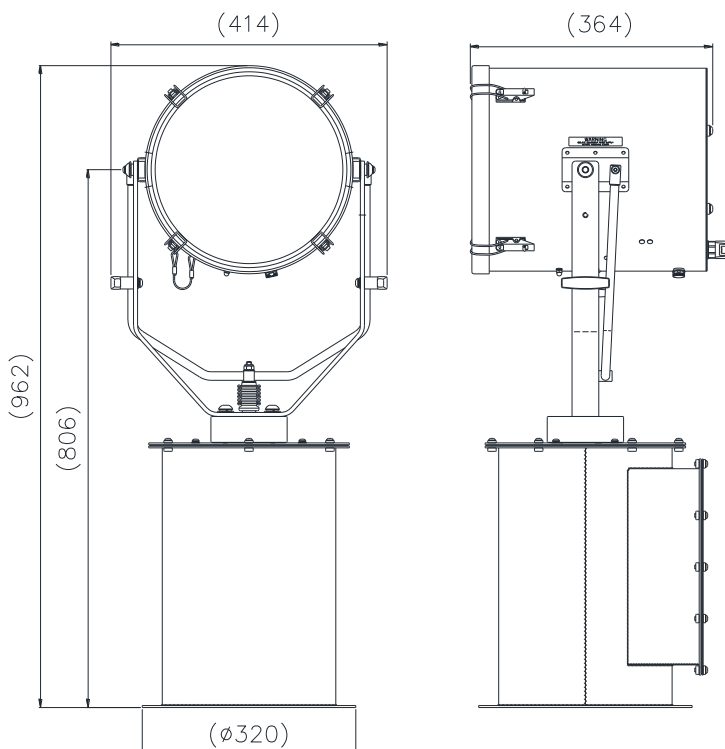

Specification		
Input voltage:	24v DC	115-240v AC
Input current:	5A Max	2A Max
Total power consumption:	120w	500w Max
Searchlight H.W.D:	962 x 414 x 364mm	
Weight:	32Kgs	
LED power:	110w	
Range @ 1 Lux:	1089m	
Divergence:	7° - 20°	
LED life (approx.)	33,000h	
Colour temperature:	6500K	
Luminous flux:	13,900 lumens	
Pan rotation:	365°	
Tilt elevation:	±35°	
Pan speed:	1 to 60°/sec	
Tilt Speed:	1 to 17°/sec	
IP rating:	IP66	
Operating temperature:	-20°C to +50°C (Optional -50°)	
Base Fixings:	4 holes 12.5 Ø on a 290mm PCD	
Joystick Control Panel	120x120mm (106 x 106mm cutout)	
Part Numbers:		
A7123 L300RC 115/240v 110w LED Remote Control Searchlight		
A7199 L300RC 24v LED Remote Control Searchlight		